

Sparkling clean in just 3 minutes! Chemical reaction lifts stains and peels them away

Patented
 Japan Patent No.5667674

THERMOS ELECTRIC BOTTLE WASHER (APA-800)

THERMOS OXYGEN BLEACH FOR ELECTRIC BOTTLE WASHER (APB-150)

Available Friday, August 21, 2015

THERMOS KK (Tokyo; Shoji Toida President), a world leader in vacuum flask products that offer people and society a lifestyle that is both comfortable and environmentally friendly, will launch its new product range for autumn/winter on Friday, August 21, 2015. As part of that new range, we are pleased to announce the launch of the new Electric Bottle Washer and Oxygen Bleach for Electric Bottle Washer, which will keep your Stainless Steel Vacuum Bottle cleaner and more hygienic.

The Thermos Electric Bottle Washer (APA-800) and Thermos Oxygen Bleach for Electric Bottle Washer (APB-150) are a revolutionary new cleaning system designed to remove tea and coffee stains from your Stainless Steel Vacuum Bottle in just three minutes. The Electric Bottle Washer and Oxygen Bleach have cut the time required to bleach stainless steel vacuum bottles down from several hours to only three minutes by lifting the stains at their roots and peeling them away.



ELECTRIC BOTTLE WASHER (APA-800)



OXYGEN BLEACH FOR ELECTRIC BOTTLE WASHER (APB-150)

After washing

*Results may differ depending on degree of staining.



Conceptualization
 (Conceptualization of Bottle Interior)



Before

After

THERMOS' PROPRIETARY PATENTED TECHNOLOGY (Japan Patent No. 5667674)

Electric current is applied, setting off a chemical reaction (radical reaction) between the bottle and the stains, lifting the stains at their roots and peeling them away.

When the body of the Thermos Electric Bottle Washer is placed on the mouth of the bottle, and an electric current is applied to the metal parts inside the bottle. This sets off a chemical reaction (radical reaction) between the bottle and the stains, which lifts the stains at their roots and peels them away. This revolutionary new cleaning system has been developed for use on Stainless Steel Vacuum Bottles.

Ordinary oxygen bleaches dissolve stains from their outer surface. The Electric Bottle Washer differs by working on the bonding plane between the bottle and the stains. When the bleach is placed in the bottle and the Electric Bottle Washer is set and switched on, cleaning is completed in just three minutes. All that remains is to rinse the bottle in cold water and gently wipe it with a sponge, and your bottle will be sparkling clean!

*Results may differ depending on degree of staining.

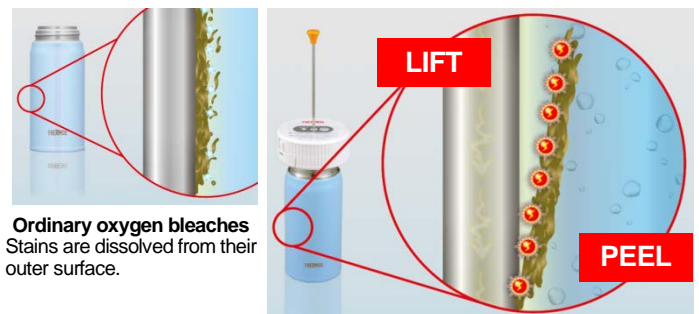

Ordinary oxygen bleaches
 Stains are dissolved from their outer surface.

ELECTRIC BOTTLE WASHER

An electric current applied to the metal parts inside the bottle sets off a chemical reaction (radical reaction), which lifts the stains at their roots and peels them away.

37.6% of users bleach their drink containers at least once a week. 14.9% do it only “when it bothers them.”

It is recommended that tea and coffee stains be removed with bleach at least once a week for hygiene reasons. This led Thermos to develop its new, original Electric Bottle Washer that makes washing your stainless steel bottles **quick and easy**.

A survey about washing drink containers with bleach revealed that the majority of respondents bleached their bottles at least once a month, with 8.9% of respondents doing so “almost every day,” 28.7% “about once a week,” and 26.6% “about once a month.”

Even if you think you are keeping your bottle clean, the tea and coffee that you put in your bottle every day leave visible stains on the bottle’s interior. Not only are these stains unsightly, but they can also be a breeding ground for bacteria, so washing your bottle with bleach at least once a week is recommended. However, bleaching with oxygen bleaches can be inconvenient, sometimes taking several hours. Moreover, incorrect care of your stainless steel bottle, such as mistakenly using a chlorine bleach on the metal parts of your bottle, could inadvertently cause damage to your stainless steel vacuum bottle.

To solve these problems, Thermos drew on its knowledge and research capabilities as a leader in stainless steel vacuum flasks, and, with its own unique ideas, developed these revolutionary new products that make washing the interior of your bottles quick and easy.

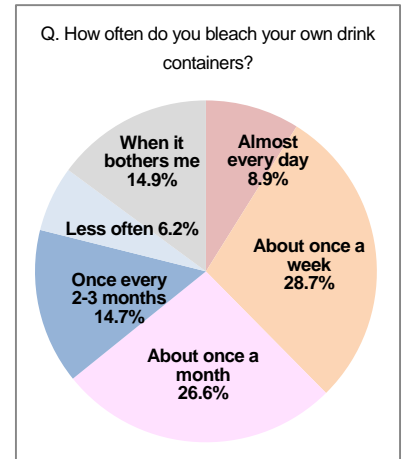

Survey by Just Research Service Co., Ltd
Web survey conducted March 2015
Respondents who look after their own water bottles
N=530

THERMOS ELECTRIC BOTTLE WASHER (APA-800)

Instructions for Use

❶ Place bleach in bottle, add water and dissolve bleach well.

❷ Remove cap from one end of electrode rod, insert rod into top of washer body, and replace cap.

❸ Place washer body on bottle and switch on.

❹ After three minutes, remove washer and rinse bottle well.

* Any remaining stains can be removed by wiping gently with a sponge.

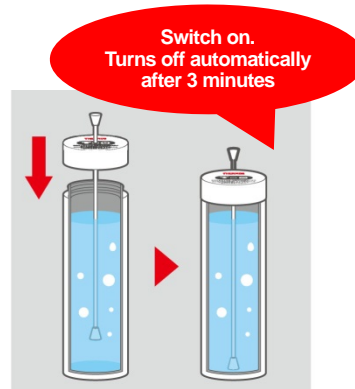
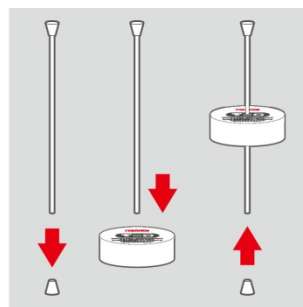
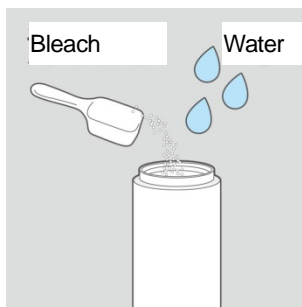

Washer body is battery operated and cordless (batteries not included).

Set Contents

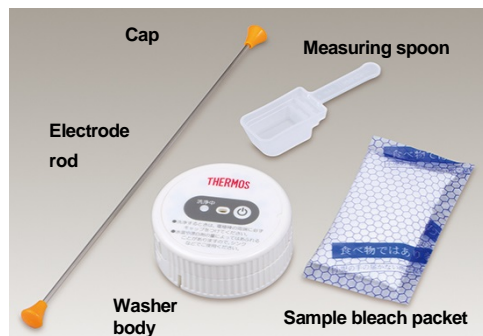

Suitable for:

The Electric Bottle Washer can be used to wash Thermos products that meet all of the following three conditions.



Capacity: ≤ 800 ml

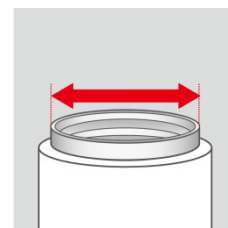

Mouth diameter:
≤ 7 cm

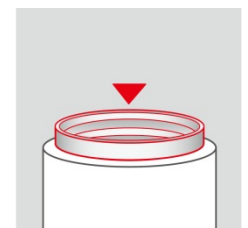

Metal rim

*Not coated with plastic

Not suitable for:

- Bottles with fluoride- or ceramic-coated interiors
- Plastic bottles

THERMOS OXYGEN BLEACH FOR ELECTRIC BOTTLE WASHER (APB-150)

Oxygen bleach for use with the Thermos Electric Bottle Washer (APA-800).

One bag contains enough bleach to wash a 500 mL bottle 16 times!



Oxygen bleach, with none of the sharp smell of other bleaches!

Can also be used to wash other parts of your bottle.

Gasket parts

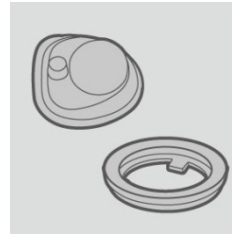

Lids and spouts



Measure bleach up to 350 mL mark on measuring spoon (6 g) and add to 1L of water. Soak parts in bleach solution for about 30 minutes, before rinsing with cold water.

■ THERMOS ELECTRIC BOTTLE WASHER (APA-800) AND THERMOS OXYGEN BLEACH FOR ELECTRIC BOTTLE WASHER (APB-150) SPECIFICATIONS

Model No.	APA-800	APB-150
RRP (ex tax)	¥3,000	¥600
JAN Code (4562344)	352932	352949
Dimensions WxDxH (approx. cm)	8x8x28	12x6x18
Weight (approx. kg)	0.1*	0.15

* Does not include weight of spoon and sample bleach packet